

H A Z E L

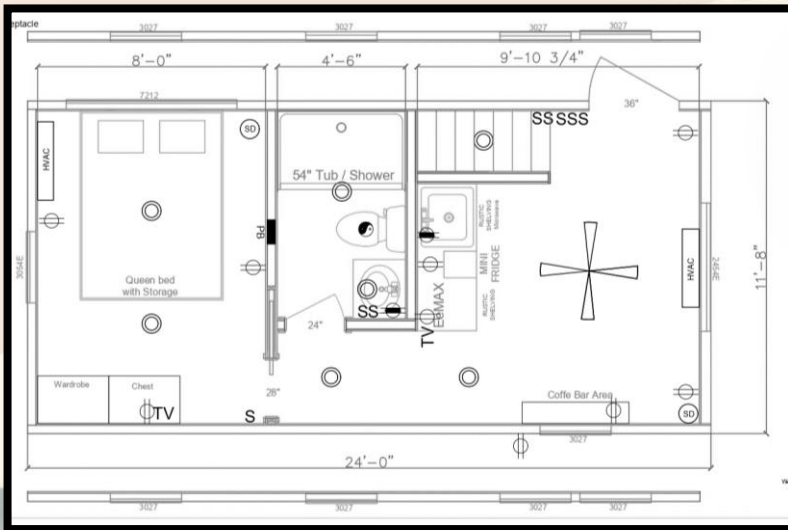

STONE CANYON
HOMES

- ✓ **Dimensions** 11'8" X 24'
- ✓ **Sq. Footage** 276
- ✓ **Bedroom** 1
- ✓ **Bathroom** 1
- ✓ **Loft** 12' 11" X 11'8"

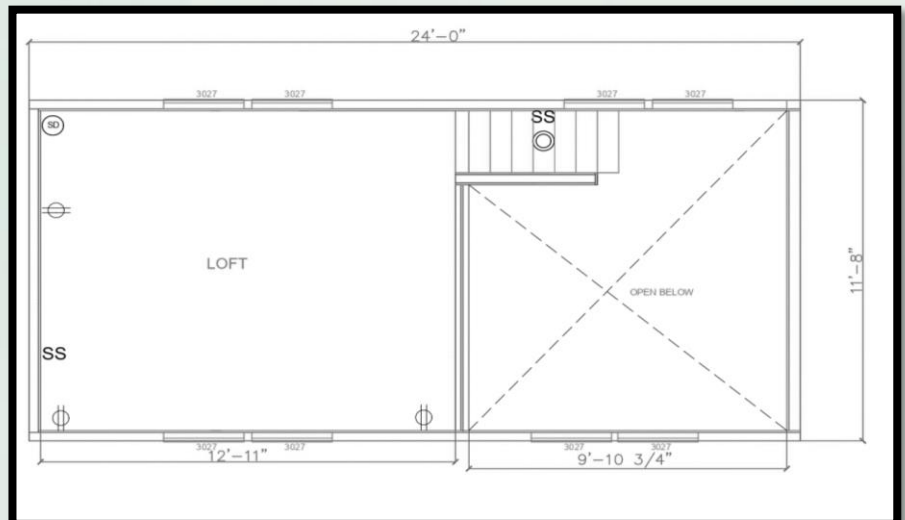

STANDARD

Insulation

- R-11 Floor, R-13 Wall, R-19 Ceiling Insulation

Flooring

- Linoleum
- Color of Choice: Shoreline, Inglewood, Crestwood, Biltmore.

Gable

- Closed Gable

Exterior Siding

Prefinished LP Smart Lap Siding

- Color of Choice: White, Cascade Slate, Summer Wheat, Aspe Ridge, Stone Blue, Rosewood.

Hardie Board

- Color of Choice: Boothbay Blue, Cobblestone, Timber Bark, Khaki Brown, Mountain Sage, Evening Blue, Gray Slate.

Prefinished LP SmartSide Textured Trim

- Color of Choice: White, Black, Match Siding.

Roof

Galvanized Sheet Metal Roof

- Color of choice: Black, Bright Red, Burgundy, Charcoal, Galvalume, Hawaiian Blue, Ivy Green, Polar White, Sahara Tan, Copper Penny.

Windows

- 1x6 Tongue & Groove Interior Walls (Sealed Natural Wood)
- Interior Wall Trim – Sealed Natural Wood

Windows

- 30"x 27" Vinyl Double Pane No Grid Window (White): 9
- 24"x54" Vinyl Double Pane No Grid Window (White): 1
- 72"x12" Vinyl Double Pane No Grid Window (White): 1

Ceiling Fans

- Ceiling Fan with Lights (Living Room)

Doors

- Interior - 28" Pocket Door (Sealed Natural Wood) -1
- Interior - 24" Swing Door (Sealed Natural Wood) -1
- Exterior 36" Half Glass Door (White)

Appliances (White & Black)

- Mini Refrigerator
- 1.6 Cu Ft Over Range Microwave

Countertops

- Rolled Edge Formica Countertops
- Color of Choice Formica – Italian, White Di Pesco, Granite – Labrador)

Cabinetry

- Kitchen – Sealed Natural Wood
- Bathroom Sink Vanity – Sealed Natural Wood

Sinks

- Kitchen – Stainless Steel Single Sink with Spring Faucet
- Bathroom – White Porcelain

Shower

- 54" Shower Stall

Water Heater

- Eemax Tankless Electric Water Heater *requires 200 AMP Power Panel

Air Conditioning

- Mitsubishi 9000 BTU Ductless Mini-Split Indoor Air Handler
- Mitsubishi 20,000 BTU Ductless Outdoor Heat Pump

200 AMP Power Panel

Smoke Detector 5"

Interior Ethernet Wiring

Interior TV outlet Wiring

Exterior Power Outlet

Fire Extinguisher 8 lb.

HAZEL

UPGRADES

Insulation

- R-22 Floor Insulation

Walls

- 1x6 Tongue & Groove Interior Walls
- Whitewash, Graywash, Painted White
- 1x8 Nickel Gap Interior Walls
- Sealed Natural Wood, Whitewash, Graywash, Painted White
- Interior Wall Trim
- Dark Walnut, Whitewash, Graywash, White, Victorian Pewter

Doors

- Exterior 36" Full Glass Door w/Built-in Blinds

Ceiling Fans

- Additional Ceiling Fan (Bedroom)

Countertops

- Quartz Countertops: Tranquility White, Silhouette
- Granite Countertops: Tranquility White, Silhouette

Shower

- 45"x48"x80" Outside Shower Kit
- Shower Door Glass

Air Conditioning

- Mitsubishi 24,000 BTU Ductless Outdoor Heat Pump

Cabinetry

- Nightstand, Medicine Cabinet w/ Mirror, Linen Cabinet, Chest of Drawers *41"x30" 20" Deep, Rustic Shelving Unit (Kitchen or Bathroom).

Bedding

- Built in Bed Frame w/Storage – Queen *Mattress not included

Additional Upgrades

- Electric Fireplace w/Hearth
- LED Under Cabinet Lighting
- Additional 30 AMP Exterior Elec Plug w/cover
- Motion Switch
- Dimmer Switch
- Bedside Light Switch
- USBc Outlet Wall Plug



STONE CANYON
HOMES