

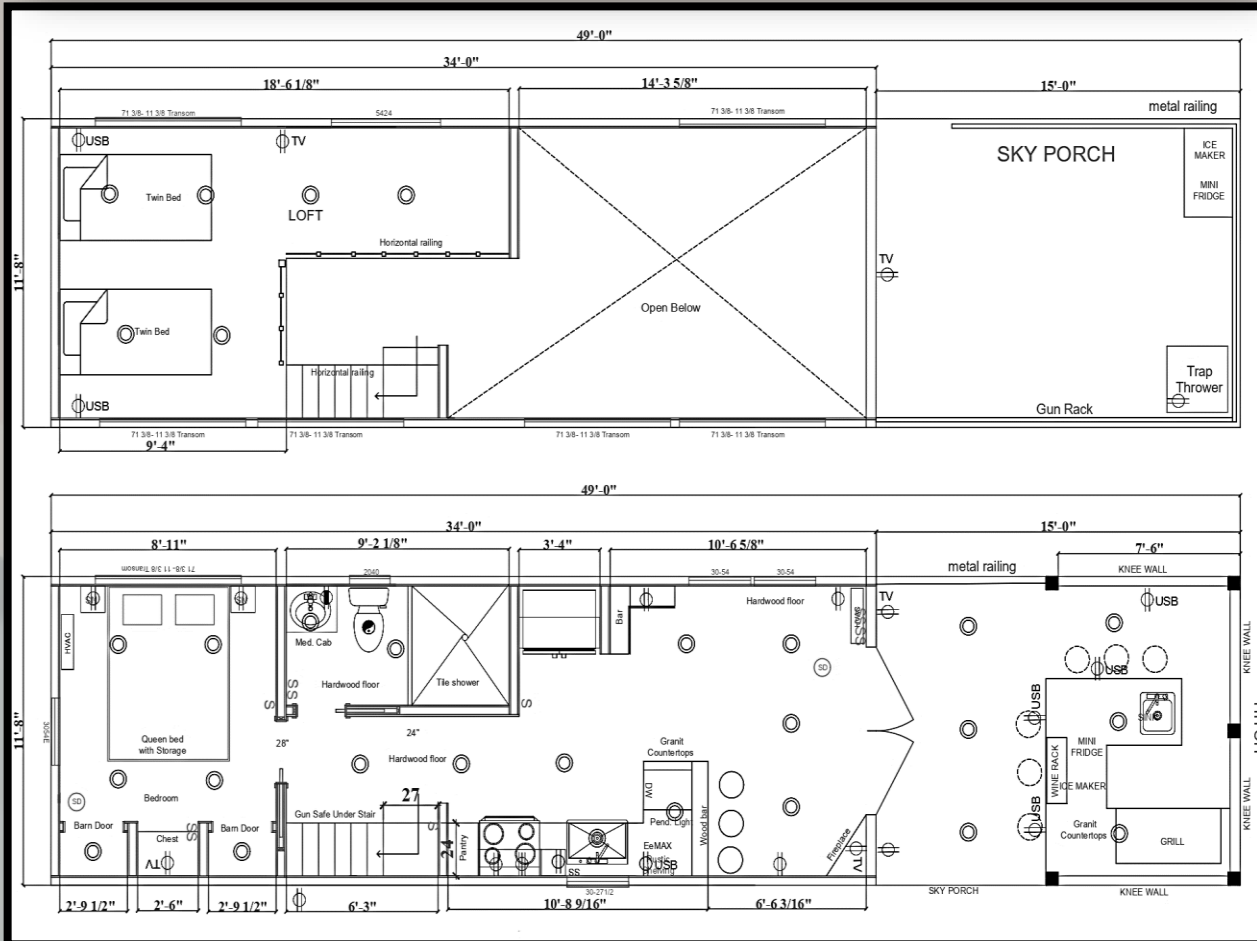

Render By Pamela Guerrero



- ✓ **Dimensions** 49' X 11'8"
- ✓ **Sq. Footage** 399
- ✓ **Deck** 15'X11'8"
- ✓ **Bedrooms** 1
- ✓ **Bath** 1

- ✓ **Exterior bar**
- ✓ **Gun safe**
- ✓ **Loft** 149 ft 2
- ✓ **Sky Porch**



D
C
K

C
N
L
M
T
E
D

STANDARD

Insulation

- R-11 Floor, R-13 Wall, R-19 Ceiling Insulation

Flooring

- hardwood flooring

Decking

- Composite color: Smoke, Campfire, Walnut
- Metal Porch Railing Panel-Matte Black

Porch Knee Wall (Bar Mini Fridge, Ice Maker, Sink, Grill ,Wine Rack)

Sky Porch (Mini Fridge And Ice Maker- Trap Thrower- Gun Rack In Railing)

Exterior Columns

- Columns on front of home (Cedar)

Exterior Siding

Prefinished LP Smart Lap Siding

- Aspen Ridge (Alder)

Prefinished LP SmartSide Textured Trim

- Cedar

Roof

Galvanized Sheet Metal Roof

- Color of choice: Copper Penny

Walls

- 1x6 Tongue & Groove Interior Walls (Sealed Natural Wood)

- Interior Wall Trim Dark Walnut

•Windows

- 30"x54" Vinyl Double Pane No Grid Window (White)3
- 30"x27" Vinyl Double Pane No Grid Window (White)1
- 54"x24" Vinyl Double Pane No Grid Window (White)1
- 72"x12" Vinyl Double Pane No Grid Window (White)6
- 16" X40 " Vinyl Double Pane No Grid Window (White)1

Doors

- Interior - 24" Pocket Door
- Interior - 28" Pocket Door
- 24" Barn Doors with Hardware
- Exterior French Door (brown)

Appliances (Black Stainless Steel)

- 4.8 Cu Ft Smooth Top Electric Range
- 18.3 Cu Ft Refrigerator plumbed for ice maker
- 1.6 Cu Ft Over Range Microwave
- 18" Dishwasher

Countertops

- Granite Countertops

Cabinetry

- Kitchen- Dark Walnut
- Bathroom Sink Vanity - Dark Walnut
- Medicine Cabinet w/ Mirror- Dark Walnut
- Rustic Shelving Unit (Kitchen) -Dark Walnut
- Chest of Drawers *41"x30" 20" Deep - Dark Walnut
- Nightstand-Dark Walnut -2

Bedding

- Built in Bed Frame w/Storage – Queen *Mattress not included
- accent wall (stone)

Sinks

- Black Farm Sink Kitchen
- Bathroom –Copper Sink With Faucet

• Shower

- Tile Shower

•Water Heater

- Tempra Tankless Electric Water Heater *requires 200 AMP Power Panel

Air Conditioning

- Mitsubishi 9000 BTU Ductless Mini-Split Indoor Air Handler-2
- Mitsubishi 20,000 BTU Ductless Outdoor Heat Pump

• Gun Safe

•Fire place in corner

•200 AMP PowerPanel

•Smoke Detector 5"

•Interior Ethernet Wiring

•Interior TV outlet Wiring

•Exterior Power Outlet on Porch

•Fire Extinguisher 8 lb.

UPGRADES

Insulation

- R-22 Floor Insulation

Decking

- 5/4 Pressure Treated Decking Natural
- Railing Stainless Steel Cable-Stainless Steel
- Railing, Porch, Horizontal Bar Powder Coated -Black w/ wood

Walls

1x6 Tongue & Groove Interior Walls

- Whitewash, Graywash, Painted White

1x8 Nickel Gap Interior Walls

- Sealed Natural Wood, Whitewash, Graywash, Painted White
- Interior Wall Trim
- Whitewash, Graywash, White, Victorian Pewter

Ceiling Fans

- Porch-Exterior Ceiling Fan w/12" Down rod
- Additional Ceiling Fan (Bedroom no loft)

Shower

- 45"x48"x80" Outside Shower Kit

Appliances

- Stainless Steel
- 5.0 Cu Ft Gas Range *Natural Gas
- 5.0 Cu Ft Gas Range *Propane

Water Heater

- Rinnai Tankless GAS Water Heater *Propane or Natural Gas

Air Conditioning

- Mitsubishi 24,000 BTU Ductless Outdoor Heat Pump

Additional Upgrades

- LED Under Cabinet Lighting
- Kitchen - Garbage Disposal
- Additional 30 AMP Exterior Elec Plug w/cover
- Bedside Light Switch
- USBc Outlet Wall Plug
- Porch TV/Ethernet Wiring

• Costume light



STONE CANYON
HOMES

DUCK UNLIMITED